

EVACUATION PLAN

**Aerovox Site
740 Belleville Avenue**

**Prepared by:
City of New Bedford
Emergency Management Department
Updated January, 2011**

Table of Contents

- I. Purpose
- II. Facility Information
- III. Hazardous Materials at Facility
- IV. Hazard Zones
- V. Evacuation Overview
 - Authority and Notification -Evacuation Actions
 - Evacuation Decision Considerations -Evacuation Transportation
- VI. Shelter
- VII. Special Needs Facilities
- VIII. Public Notification
- IX. Evacuation Movement and Routes
- X. Alternate Transportation
- XI. Re-Entry
- XII. Agency Responsibilities

Appendices

- Appendix 1 Aerovox Site Location Map
- Appendix 2 Aerovox Manufacturing Building Site Plan
- Appendix 3 Evacuation Zone Maps
- Appendix 4 Special Needs Facilities in Evacuation Zones
- Appendix 5 Evacuation Action Checklist
- Appendix 6 Local Broadcast Media
- Appendix 7 Alternate Transportation Resources

EVACUATION PLAN

Aerovox Site

I. PURPOSE

This evacuation plan was developed to provide for an orderly and coordinated evacuation should a fire or other incident occur at the Aerovox Site.

II. FACILITY INFORMATION

Facility Name:	Aerovox Facility Site (Fire Dept. Box# 2261)
Facility Address	740 Belleville Avenue New Bedford
Facility Telephone Number:	N/A
Facility Emergency Contact :	James Ricci, Superintendent of Water City of New Bedford Work: 508-979-1603 Cellular: XXX-XXX-XXXX

The Aerovox site consists of a 450,000 sq. ft. former manufacturing building located on approximately 10 acres of industrial-zoned land.

This building, previously used to manufacture capacitors and related products, consists of a western section that contains two floors and an eastern section that contains three floors. The first floor in both the eastern and western sections of the building is constructed of concrete. Structural components of the building include interior wood columns and steel I-beam floor joists. Wooden floors are present on the second floor of the western section of the building

Aerovox and various predecessor companies had occupied the site for approximately 90 years. In April, 2001, Aerovox relocated to a new facility at New Bedford Business Park and two months later filed for bankruptcy. The Belleville Avenue facility has been vacant since that time.

From C1940 to C1977, polychlorinated biphenyls (PCBs) were used at the facility in the manufacture of electrical capacitors and transformers. As a result of this manufacturing history, very high levels of PCBs within the interior of the building and the presence of PCBs in uncapped soils outside the building have been identified. Additionally, asbestos is present along with a sizeable quantity of elemental mercury has also been identified in the building both in equipment and spilled on the floor.

III. HAZARD INFORMATION

The Aerovox site is located within a highly developed urban/industrial area of the city. The Acushnet River borders the site to the east. The ground surface at the site slopes gently from the west to the east.

Since being vacated in 2001, significant deterioration has occurred including increased roof leaks and heavy water damage throughout the building. Trespassing and vandalism (and the potential for tracking contamination off-site) are a recurring problem, although the city continues to take measures to minimize this threat.

The long-term vacancy of the building poses a significant fire threat. Should a fire erupt in the deteriorating building, burning materials would emit airborne PCBs, asbestos and potentially other more toxic fumes like dioxins and furans. Contaminated water from fighting the fire would run-off into the harbor.

See Appendix 1 for a Site Location Map

See Appendix 2 for the Manufacturing Building Site Plan

IV. EVACUATION ZONES

For evacuation guidance purposes, three evacuation zone maps have been developed ranging from a 500 foot area progressing to a 1/2 mile area. These maps may also be used if a smaller evacuation area is appropriate. The actual evacuation area, if any, for an incident at the Aerovox site will be determined by the Incident Commander.

These maps may be found in Appendix 3:

- a. 500 Foot Hazard Zone Map
- b. 1/4 Mile Hazard Zone Map
- c. 1/2 Mile Hazard Zone Map

Within these zones, Special Needs Facilities (such as day care facilities, housing complexes where the residents are predominantly elderly or handicapped, and schools) where special considerations including advance notification and/or special evacuation transportation may be necessary have been identified.

V. EVACUATION OVERVIEW

Authority and Notification

The city's primary public safety response to an incident at the Aerovox site is the protection of the neighborhood - its residents and property. Such protective actions include evacuation of effected and potentially effected residents and providing temporary shelter for those in need of same.

The Mayor, acting through the Emergency Management Director, is ordinarily the overall authority for directing an evacuation in the city of New Bedford. However, in situations where there may be an urgent and immediate need to evacuate a limited area for the health and safety of the population (such as for an incident at Aerovox), the Fire Department on-scene commander/Incident Commander may order such an evacuation which will be carried out by Police Department personnel.

The Incident Commander will ensure that the Mayor and Emergency Management Director are notified of the situation so that the responsibility for coordination of support services and any additional evacuations can transfer to these individuals working in conjunction with the senior Police Department official on scene. This coordination will occur on-scene or at the city's Emergency Operations Center, depending on the magnitude and anticipated duration of the evacuation.

Evacuation Actions

The Evacuation Action Checklist found in Appendix 5 may be used as a guide should an evacuation for an incident at this facility be necessary.

Evacuation Decision Considerations

When ordering an evacuation, there are several factors which must be considered. These include:

- magnitude of incident (if hazardous materials incident - rate of release, quantity of release, etc) weather conditions
- availability and readiness of shelter for evacuees
- staging areas and transportation resources for evacuees unable to provide their own, and location in the evacuation area of special need facilities.

Decision about whether or not to evacuate, as well as about evacuation distances, are incident specific and must be made at the time of an actual or threatened release. The Incident Commander will ensure the evacuation area is defined in terms clearly understandable by the Police Department and the general public, and that this information is provided to the Public Information Officer for rapid distribution to the media.

The hazard situation will be continually monitored in case changing circumstances such as wind shift requires redefinition of the evacuation area.

Evacuation Transportation

The primary means of transportation during evacuation is private automobile. Individuals without access to an automobile will be transported by bus. In addition, specialized vehicles such as ambulances and wheel chair vans may be required to transport certain evacuees. See Section XI for more information.

VI SHELTER

In the event an evacuation is necessary, evacuees will be advised to seek shelter at homes of friends or relatives living a safe distance away from the facility. Evacuees may also seek refuge in a mass care shelter that would be opened and operated by the city and the American Red Cross.

The city has designated the following as the primary Mass Care Shelter should an evacuation be necessary:

**New Bedford High School
230 Hathaway Boulevard**

New Bedford High School is well outside any evacuation area which may be established. In the event this facility is not available when an evacuation is required, it will serve as a reception center where evacuees will be directed to (and transported if needed) to an alternate site.

If necessary, the Normandin Middle School, 81 Felton Street, could be activated as a reception center for evacuees to meet other family members and/or secure transportation to New Bedford High School. It should be noted, however, that Normandin Middle School is located on the fringe of the 1/2 Mile Evacuation Zone.

VII. SPECIAL NEEDS FACILITIES

Facilities which are expected to require special planning and resources to carry out evacuations include schools and day care centers, medical facilities, residences and recreation facilities for handicapped or disabled. All facilities of this type within the area to be evacuated will be warned of the emergency situation, if time permits.

For planning purposes, special needs facilities within a one-half mile radius of the facility have been identified and are listed in Appendix 4, along with detailed profiles for each.

VIII. PUBLIC NOTIFICATION

Evacuation Warning

The use of emergency vehicles (primarily police) traveling through the affected area with sirens and public address systems, along with door-to-door notification (particularly in areas close to the facility) will be the primary means of warning.

Additionally, an emergency telephone notification system operated by the Plymouth County Sheriff's Office can be accessed to provide geographic-based call-out announcements to the designated evacuation area, as well as to provide advance notice that an evacuation could be imminent.

Secondarily, warnings will be issued through the local broadcast media and cable television Government Access Channel (Channel 18) to the extent possible.

Emergency Public Information

The Public Information Officer (PIO) will ensure evacuation information is distributed to the broadcast media on a timely basis. Instructions to the public, such as location of shelter, as well as situation updates will be issued as that information becomes available.

A listing of local broadcast media may be found in Appendix 6.

IX. EVACUATION MOVEMENT AND ROUTES

It is assumed most of the affected population will evacuate by private vehicle. Actual evacuation movement efforts, including establishment of evacuation routes, will be coordinated by the senior Police Department official on scene, as needed. Any necessary evacuation movement instructions will be part of the evacuation warning and subsequent public information releases.

Traffic control devices such as signs and barricades may be requested from the Departments of Public Facilities and Public Infrastructure.

X. ALTERNATE TRANSPORTATION

Alternate transportation for those without access to private automobiles will be provided by public and/or private transportation (bus) resources. The senior Police Department official on-scene, working with the Mayor and Emergency Management Director, will activate necessary alternate transportation resources

Additionally, they will designate alternate transportation pick-up points, as needed, and provide this information to the Public Information Officer.

A listing of transportation resources and contact information may be found in Appendix 7.

XI. RE-ENTRY

Reoccupation of an evacuated area requires the same consideration, coordination, and control as in the original evacuation. The re-entry decision and order will be made by the Incident Commander. Some specific re-entry considerations are:

- Ensure the threat which caused evacuation is over and the evacuated area is safe to return to.
- Ensure that structures which may have been damaged have been inspected to determine if they are safe to return to.
- Determine the number of persons in shelter who will have to be transported back to their homes and make appropriate transportation arrangements.
- Coordinate traffic control and movement back to the area.
- Inform the public of any needed re-entry actions.

XII. LOCAL RESPONSE AGENCY RESPONSIBILITIES

Fire Department

- Responsible for on-scene control through utilization of the Incident Command system.
- Evaluate situation, advise on protective actions and provide recommendations for evacuation decision.
- If there is an immediate threat to life and safety, define appropriate evacuation area and order implementation by Police Department

Police Department

- In conjunction with the Incident Commander and Emergency Management Director, establish specific evacuation zone and initiate evacuation activities.
- Establish perimeter around evacuation zone and control access.
- Provide property protection in evacuated areas.

Emergency Medical Services Department

- Provide evacuation assistance, as resources allow, for non-ambulatory evacuees.
- Coordinate the procurement of additional ambulance resources through mutual aid.

Emergency Management Director

- Develop and update facility evacuation plan.
- Coordinate evacuation effort with senior Police and EMS Department officials.
- Open and staff the Emergency Operations Center, if appropriate.

Departments of Public Facilities/Public Infrastructure

- Assist Police Department with perimeter control by providing barriers.

School Department

- Coordinate bus transportation for evacuation.
- Open school facility to be used as Mass Care Shelter.

Public Information Officer

- Provide evacuation instructions and related information through local media.

Cable Access Department

- Disseminate warnings and emergency public information via the Government Access Channel on local cable television system.

Other City Departments

- Provide necessary services as may be required by the nature of the incident and their resources to meet the emergency.

American Red Cross

- Operate mass care shelters for evacuees.

Special Needs Facilities (Except Housing Complexes)

- Provide evacuation transportation for students/clients/patients

APPENDICES

Appendix 1	Aerovox Site Location Map
Appendix 2	Aerovox Manufacturing Building Site Plan
Appendix 3	Evacuation Zone Maps
Appendix 4	Special Needs Facilities in Evacuation Zones
Appendix 5	Evacuation Action Checklist
Appendix 6	Local Broadcast Media
Appendix 7	Alternate Transportation Resources

Appendix 1

Aerovox Site Location Map



REFERENCE: NEW BEDFORD NORTH, MASS. USGS QUADS., 7.5 MIN. SERIES, 1979.

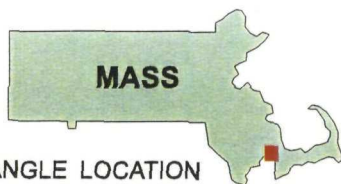
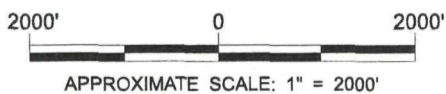

Aerovox INC.
 740 BELLEVILLE AVE., NEW BEDFORD, MA 02745 USA
 ENGINEERING EVALUATION/COST ANALYSIS (EE/CA)

SITE LOCATION PLAN

BBL BLASLAND, BOUCK & LEE, INC.
 engineers & scientists

FIGURE
2

Appendix 2

Aerovox Manufacturing Building Site Plan

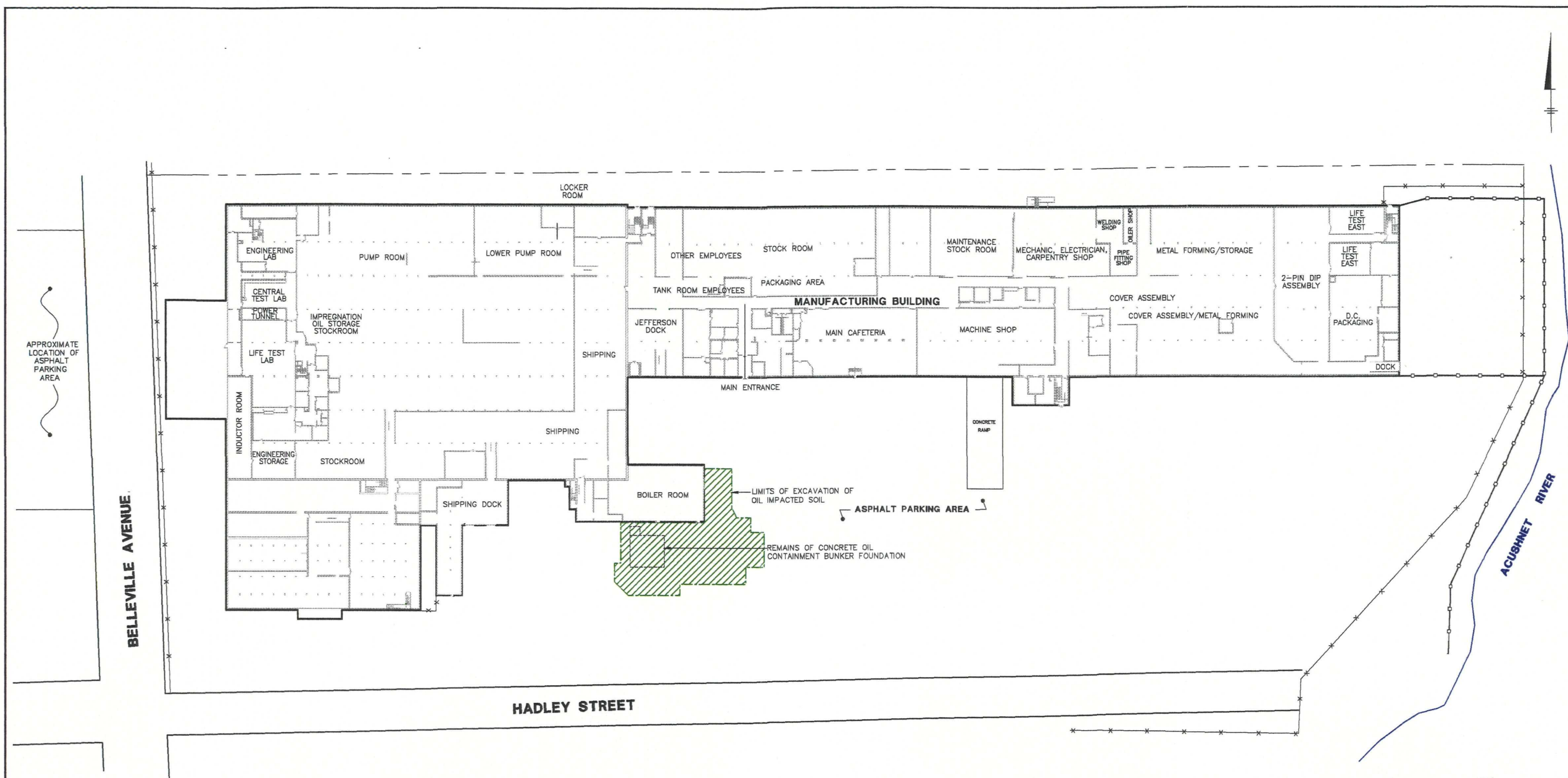

NOTES

1. EXTERIOR AND INTERIOR BUILDING WALL LOCATIONS WERE OBTAINED FROM AN ELECTRONIC FILE (DRAWING NO. PAVXX-AG-0002, REVISION A, DRAWN BY D. JENKINS, DATED NOVEMBER 18, 1997) PROVIDED BY AEROVOX, INC.
2. SITE FEATURES OUTSIDE THE BUILDING (INCLUDING FENCE, PROPERTY LINE, PARKING LOT, AND ROADWAYS) WERE DIGITIZED FROM A SITE PLAN AT A SCALE OF 1"=50' PREPARED BY INDUSTRIAL RISK INSURERS, DATED MAY 8, 1992.
3. THE LIMIT OF THE FORMER SOIL EXCAVATION AT AND IN THE VICINITY OF THE CONCRETE OIL CONTAINMENT BUNKER FOUNDATION (WHICH FORMERLY SUPPORTED TWO 10,000 GALLON OIL STORAGE TANKS) WAS DIGITIZED FROM A DRAWING ENTITLED, "CONSTRUCTION SITE PLAN, SHORT TERM MEASURE, AEROVOX, INC.," PREPARED BY SAIC ENGINEERING, INC. AT A SCALE OF 1"=10', DATED JUNE 4, 1991.
4. LOCATION OF FENCE ALONG EAST PROPERTY LINE DETERMINED FROM FIELD OBSERVATIONS.

LEGEND

- x-x-x- EXISTING FENCE
- - - - - EXISTING PROPERTY LINE
- o-o-o- SHEET PILING (APPROXIMATE LOCATION)

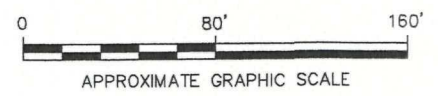

X (XREF)
 LAYERS OFF=0, CONCRETE FLOOR, FIG3, REF, SAMPLE LOCATION, SCRAPES, SEALED AREAS, WIPES, WOOD LOT
 P: AERO.PCP
 6/27/98 DIV54-RCB, PGL, RCB, JMS
 03855005/03855SM4

Aerovox[®] INC.
 740 BELLEVILLE AVE., NEW BEDFORD, MA 02745 USA
 ENGINEERING EVALUATION/COST ANALYSIS (EE/CA)

MANUFACTURING BUILDING

BBL BLASLAND, BOUCK & LEE, INC.
engineers & scientists

FIGURE
3

Appendix 3

Evacuation Zone Maps
Aerovox Site

- 500 Foot Evacuation Zone
- 1/4 Mile Evacuation Zone
- 1/2 Mile Evacuation Zone

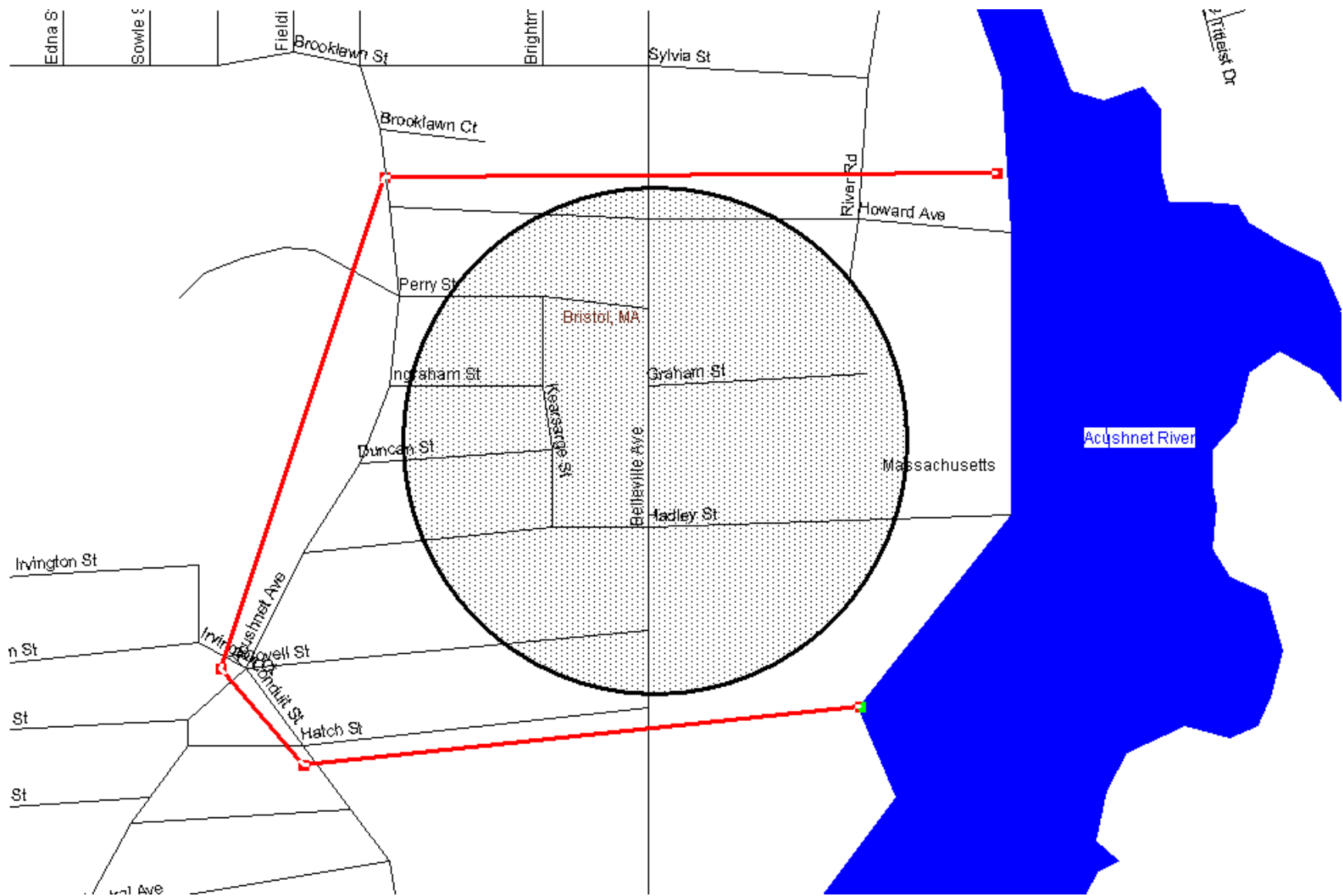

Aerovox Facility - 500' Evacuation Zone

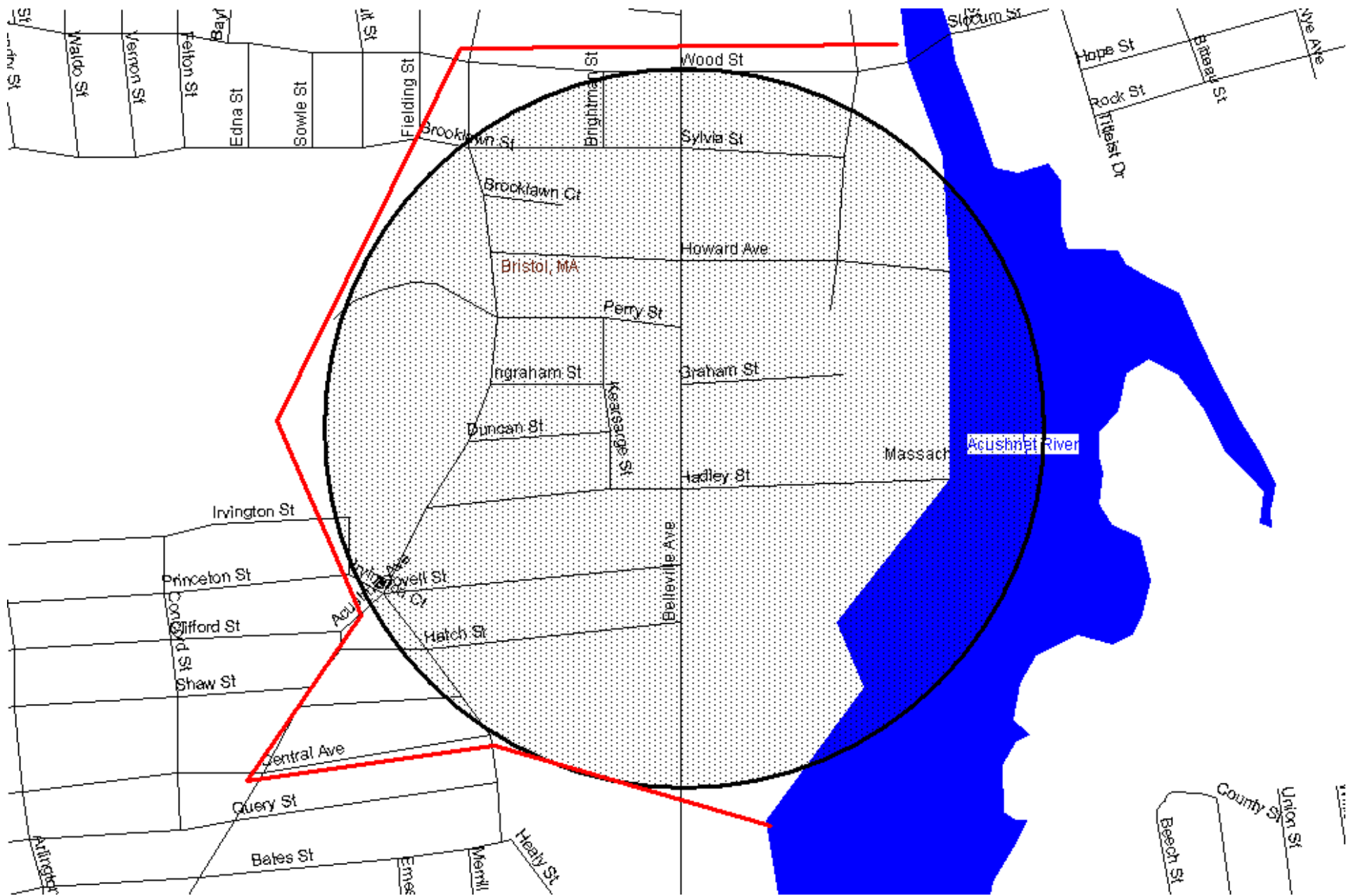

Aerovox Facility - 1/4 Mile Evacuation Zone

Appendix 4

Special Needs Facilities

Facility Name and Address	Population Clients/Staff	Point of Contact	Telephone
<i>500 Foot Evacuation Zone</i>			
None identified			
<i>1/4 Mile Evacuation Zone</i>			
None identified			
<i>1/2 Mile Evacuation Zone</i>			
Jirah Swift School 2203 Acushnet Avenue	220/20	Debra Letendre, Principal	508-997-4511, Ext. 2247
Children's Paradise Day Care 4 Waldo Street	30/10	Rosa Cabral, Owner	508-995-7778
Ashley School 122 Rochambeau Street	320/30	Karen Meyer, Principal	508-997-4511, Ext. 2240
Whaler's Cove 114 Riverside Avenue	120/	Maureen Costa, Exec. Director	508-997-2880

NEW BEDFORD - SPECIAL INSTITUTIONS

Facility Name: Swift School			
Facility Address: 2203 Acushnet Avenue		Zip: 02745	
Contact: Debra Letendre, Principal		Phone: 997-4511, X2247	
Peak Population (not counting) 220	Avg. Ambulatory:Population: 220		Avg. Non-Ambulatory Pop.: 0
Avg. Daily Staff:			
Generator on site? No			
Does facility have its own transportation to evacuate residents? No			
If not list provider: School Transportation Providers			
Is special transportation needed? No			
List facility's evacuation destination: see Note below			
Are there formal agreements to shelter evacuated residents?: No			
Assisted Living? No		Nursing Home? No	
Camp? No		Prison? No	
Child Care? No		School, College/University? No	
Half -way Housing? No		School, Private? No	
Mobile Home Park? No		School, Public? Yes	
Other (See notes below)?			
Notes: Evacuation Destination: Ashley School, 122 Rochambeau Street			

NEW BEDFORD - SPECIAL INSTITUTIONS

Facility Name: Children's Paradise - Waldo			
Facility Address: 4 Waldo Street		Zip: 02745	
Contact: Rosa Cabral, Owner		Phone: 508-995-7778	
Peak Population (not counting) 30	Avg. Ambulatory:Population: 30	Avg. Non-Ambulatory Pop.: 0	
Avg. Daily Staff:			
Generator on site? No			
Does facility have its own transportation to evacuate residents? No			
If not list provider:			
Is special transportation needed? Yes			
List facility's evacuation destination: Hayden-McFadden School, 361			
Are there formal agreements to shelter evacuated residents?: No			
Assisted Living? No	Nursing Home? No		
Camp? No	Prison? No		
Child Care? Yes	School, College/University? No		
Half -way Housing? No	School, Private? No		
Mobile Home Park? No	School, Public? No		
			Other (See notes below)?
Notes: Group child care facility operating 6:30 AM - 5:30 PM, M-F Average Staff = 9			

NEW BEDFORD - SPECIAL INSTITUTIONS

Facility Name: Ashley School			
Facility Address: 122 Rochambeau Street		Zip: 02745	
Contact: Karen Meyer, Principal		Phone: 997-4511, X2240	
Peak Population (not counting) 320	Avg. Ambulatory:Population: 320	Avg. Non-Ambulatory Pop.: 0	
Avg. Daily Staff:			
Generator on site? No			
Does facility have its own transportation to evacuate residents? No			
If not list provider: School Transportation Providers			
Is special transportation needed? No			
List facility's evacuation destination: see Note below			
Are there formal agreements to shelter evacuated residents?: No			
Assisted Living? No	Nursing Home? No		
Camp? No	Prison? No		
Child Care? No	School, College/University? No		
Half -way Housing? No	School, Private? No		
Mobile Home Park? No	School, Public? Yes		
Other (See notes below)?			
Notes: Evacuation Destination: Lincoln School, 445 Ashley Boulevard			

NEW BEDFORD - SPECIAL INSTITUTIONS

Facility Name: Whaler's Cove			
Facility Address: 114 Riverside Ave		Zip: 02746	
Contact: Maureen Costa, Executive Director		Phone: 508-997-2880	
Peak Population (not counting) 120	Avg. Ambulatory:Population: 120		Avg. Non-Ambulatory Pop.: 0
Avg. Daily Staff:			
Generator on site? No			
Does facility have its own transportation to evacuate residents? No			
If not list provider:			
Is special transportation needed? No			
List facility's evacuation destination:			
Are there formal agreements to shelter evacuated residents?: No			
Assisted Living? Yes		Nursing Home? No	
Camp? No		Prison? No	
Child Care? No		School, College/University? No	
Half -way Housing? No		School, Private? No	
Mobile Home Park? No		School, Public? No	
Other (See notes below)?			
Notes: Assisted living facility. 120 unit, 2-story building			

Evacuation Action Check List

√	ACTION
	<p>If time permits and potential exists for an evacuation, provide advance notifications:</p> <ul style="list-style-type: none"> - Special needs facilities that may need to be evacuated - Transportation resources of likely activation. - American Red Cross and School Department for shelter activation.
	Define evacuation area by readily definable boundaries.
	Designate alternate transportation pick-up points and/or routes for evacuees in need of transportation
	Designate alternate transportation resource staging area
	Activate American Red Cross and School Department for shelter facility opening, if not already done.
	<p>Activate transportation resources:</p> <ul style="list-style-type: none"> - Public resources (i.e. School Department, etc.) for transportation of evacuees without their own transportation. - Private resources (Tremblay Bus Company, etc.) for transportation of evacuees without their own transportation, special needs individuals (i.e. chairvans), etc.
	Initiate formal evacuation activities when necessary
	<p>Prepare evacuation instructions for police and other personnel providing evacuation warning:</p> <ul style="list-style-type: none"> - Incident/emergency (Why they are being asked/ordered to evacuate) - What they should do (i.e. "Leave your home immediately...") - Where they should go (i.e. "Go to a home of a friend or relative out of emergency area", "Go to the Red Cross Shelter at the _____ School", etc.) - Where to go if they need transportation to a shelter or safe area
	Prepare evacuation notification announcement for emergency telephone notification system, if system will be used.
	<p>Provide evacuation warning by appropriate means:</p> <ul style="list-style-type: none"> - Area route alerting though evacuation area - Door-to-door notification where deemed necessary - Emergency telephone notification system (Plymouth Cty. Sheriff's Off.)

	<ul style="list-style-type: none">- Regular announcement by local broadcast media- Continual announcements on Cable Access channels- Cable TV system override
	Open and staff mass care shelter(s)
	Establish traffic and perimeter control as needed.
	Provide ongoing emergency public information activities.
	Provide police protection for evacuated areas where it is safe to do so.
	Through continual monitoring of the situation, redefine areas at risk and evacuate additional areas if necessary.

Appendix 6

Local Broadcast Media

RADIO:	Main Phone	News Room	News Fax
WBSM - AM 1420 WFHN - FM 107.1 22 Sconticut Neck Rd. Fairhaven 02719	(508) 993-1767 (508) 999-6690	(508) 997-7936 “	(508) 999-1420 “
WNBH - AM 1340 888 Purchase Street, New Bedford 02740	(508) 979-8003		(508) 979-8009
WJFD - FM 97.3 651 Orchard Street, Ste 300, New Bedford 02744	(508) 997-2929		(508) 990-3893

TELEVISION

Providence Market

WLNE - Channel 6 10 Orms Street, Providence, RI 02904	(508) 992-6666	(401) 453-8044	(401) 453-8092
WJAR - Channel 10 23 Kenney Drive, Cranston, RI 02920	(401) 455-9100	(401) 455-9105 Email: news@wjar.com	(401) 455-9140
WPRI - Channel 12 and WNAC – Channel 64 25 Catamore Boulevard, Providence, RI 02903	(401) 438-7200	(401) 438-2310	(401) 431-1012

Boston Market

WBZ - Channel 4 and WSBK – Channel 38 1170 Soldiers Field Rd, Boston 02134	(617) 787-7000	(617) 787-7145 Email: newstips@wbztv.com	(617) 254-6383
WCVB - Channel 5 5 TV Place, Needham, MA 02194	(617) 449-0400	(617) 433-4560	(617) 449-6681
WHDH- Channel 7 and WLVI – Channel 56 7 Bullfinch Place, Boston 02114	(617) 725-0777	(617) 725-0775	(617) 723-6117
WFXT - Channel 25 25 Fox Drive, Dedham, MA 02026	(781) 467-2525	(781) 467-1300	(781) 467-7213

- continued -

NETWORKS

New England Cable News Network (NECN)
(617) 630-5000 (617) 630-5000 (617) 630-5057
160 Wells Avenue, Newton, MA 02459 Email: newsdesk@necn.com

LOCAL CABLE TELEVISION

New Bedford Cable Access (508) 979-1775 (508) 979-1764
918 So. Rodney French Blvd, New Bedford, MA 02744

NEWSPAPERS

Standard-Times (508) 997-7411 (508) 979-4450 (508) 997-7491
25 Elm St, New Bedford, MA 02740 [Email: Newsroom@S-T.com](mailto:Newsroom@S-T.com)

Portuguese Times (Weekly) (508) 997-3118 (508) 990-1231
1501 Acushnet Avenue / PO Box 61288, New Bedford, MA 02746

Cape Cod Times (508) 775-1200 (508) 862-1232 (508) 771-3292
319 Main Street, Hyannis, MA 02601 Email: news@capecodonline.com

Boston Globe (617) 929-2000 (617) 929-3100 (617) 929-3186
135 Morrissey Blvd, Boston, MA 02125

Boston Herald (617) 426-3000 (617) 542-1315
1 Herald Square, Boston, MA 02106

Providence Journal (401) 227-7000
75 Fountain Street, Providence, RI 02902
PJ – East Bay Bureau (508) 674-8401 (508) 674-8401 (508) 676-6140
14 Gooding Avenue, Bristol, RI 02809 Email: massbureau@projo.com

Alternate Transportation Resources

Name/Contact	Address/Telephone*	Resources Available
<i>Public Transportation</i>		
New Bedford School Department Larry Oliveira, Chief Administrator - Finance and Operations	455 County Street 508-997-4511, Ext. 3268	School Department will coordinate activation of contracted resources including Reliable Bus Company
New Bedford Council on Aging Felice Monteiro, Director	181 Hillman Street 508-991-6250	4 EA wheelchair vans 1 EA 15-passenger van
<i>Private Transportation</i>		
Reliable Bus Lines, Inc. Margarita Alago General Manager/Vice President	978 Nash Road New Bedford, MA 508-992-0342	Primary school transportation provider. Resources include traditional school busses and wheelchair lift-equipped buses and vans.
Tremblay Bus Company Luke Tetreault	284 Myrtle Street 508-999-6436	Resources include traditional school busses and wheelchair lift-equipped buses and vans.

* - 24-hour contact information on file for all resource providers

Revised 12/10