



September 26, 2019

Ref: 12815.00

Mr. Craig P. Dixon, Chairman  
New Bedford Conservation Commission  
133 William Street, Room 304  
New Bedford, MA 02740

Attn: Ms. Sarah Porter Conservation Commission Agent

Re: DEP File No. SE 049-0805  
Request to Perform Test Pit in Wetland Resource Area  
New Bedford, Massachusetts

Dear Chairman Dixon,

On behalf of the Massachusetts Department of Transportation, VHB respectfully submits this request to perform a test pit in an existing wetland resource area approximately 700' south of Tarkiln Hill, on the east side of the existing tracks. Based on our previous surveys, there is an existing Drain Manhole (DMH) in this location that is full of debris and water, and on a recent site visit the cover was not visible and buried. Also, based on record plans there was a 24" Reinforced Concrete Pipe (RCP) that passed under the track from the DMH to the existing open drainage ditch on the west side of the track. During the recent construction of the new, widened ditch, the contractor exposed the pipe outlet and determined that the pipe at the ditch lead to an unknown granite box culvert and that the pipe did not continue under the track as originally thought.

The SCR team needs to determine the limits of the granite box culvert and verify the size and invert of pipes and box culverts entering and leaving the DMH on the east side of the track. We plan to re-expose the DMH cover and attempt to determine inverts and pipe of box culvert sizes from inside the DMH. However, if inspection of the interior of the DMH does not provide us with the critical data we need, then the only way to make this determination will be to expose these pipes and culvert on the outside of the DMH. We also need to expose the top of the existing box culvert to verify its extents. The limits of excavation are shown in the attached plan. They are temporary and minimal. Any hydric soil excavated will be stockpiled separately from subgrade soils. Both hydric and subgrade soils will be stockpiled outside the resource area limits shown. The total volume anticipated will be less than 10 CY. All excavation areas will be backfilled with the soils excavated, placing the hydric soils on the surface lift and

**Engineers | Scientists | Planners | Designers**

101 Walnut Street  
PO Box 9151  
Watertown, Massachusetts 02471  
P 617.924.1770  
F 617.924.2286

Mr. Craig P. Dixon  
Ref: 12815.00  
September 26, 2019  
Page 2



the excavation area will be reseeded with the wetland seed mix approved by the Commission in our Order of Conditions.

This detailed investigation is needed so that our design team can provide accurate design plans for replacing the existing granite box culvert. The plans, once completed, will be issued to the Conservation Commission via request for minor modification to our current Order of Condition, with the request that the Commission review and authorize the SCR team to replace the culvert per the plans submitted.

We respectfully request that the Commission hear us on this matter at their next Conservation Commission hearing, Wednesday, October 2, 2019. If you have any questions or require additional information before then, please contact me via email at [lcarlson@vhb.com](mailto:lcarlson@vhb.com) or by phone at (617) 607-6237.

Sincerely,

Vanasse Hangen Brustlin, Inc.

A handwritten signature in blue ink, appearing to read "Lars Carlson", with a long horizontal flourish extending to the right.

Lars Carlson

Senior Project Manager  
lcarlson@vhb.com

CC: Jean Fox, MassDOT  
Holly Palmgren, MBTA  
MassDEP, Southeast Regional Office, Attn: Mark Bartow

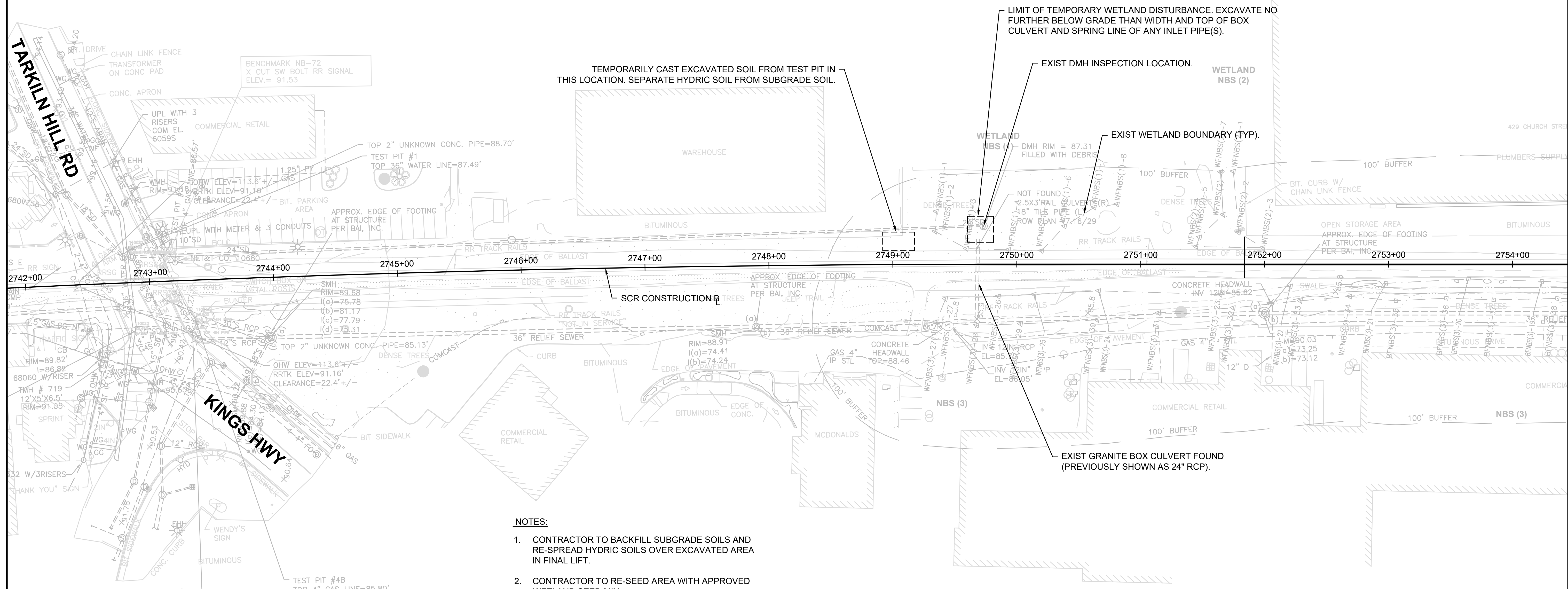
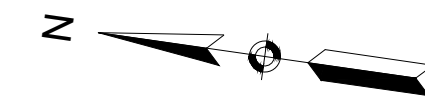

- NOTES:**
1. CONTRACTOR TO BACKFILL SUBGRADE SOILS AND RE-SPREAD HYDRIC SOILS OVER EXCAVATED AREA IN FINAL LIFT.
  2. CONTRACTOR TO RE-SEED AREA WITH APPROVED WETLAND SEED MIX.

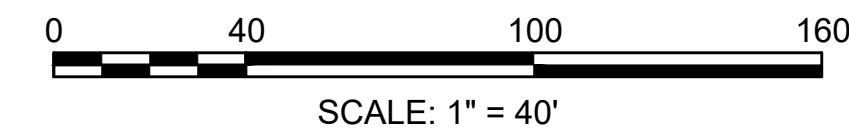

SOUTH COAST RAIL - PHASE I  
EARLY ACTION CULVERTS & TARKILN HILL ROAD

**NEW BEDFORD MAIN LINE  
TARKILN HILL ROAD  
TEST PIT PLAN**

ISSUE		DATE	DESCRIPTION	BY	CHKD.	APP.
<p>PROJECT MANAGER: <b>vhb HNTB</b> 99 HIGH STREET, BOSTON, MA 02110 (617) 728-7777</p>						
HORIZ: AS SHOWN		DES. BY	DR. BY	CHK. BY	Date	
VERT: NONE		CSS	KJC	KJC		
DATE: 9/26/2019						
				PLAN NO.		ISSUE
				SHEET 1		